

NOTE:
ALL LAND USE SHADING BASED ON FOREST INVENTORY MAPPING (1996/2000)

PROPOSED ALIGNMENT
NEW ROUTE 2 TRANS-CANADA HIGHWAY PROJECT
PERTH-ANDOVER TO WOODSTOCK

Date: 2004 02 03
Job No.: 14677

Scale: 1 : 20 000
Fig. No.: 3.2-A

Jacques Whitford
Consulting Engineers
Environmental Scientists

THIS DRAWING IS THE PROPERTY OF JACQUES WHITFORD AND IS NOT TO BE REPRODUCED OR TRANSMITTED IN ANY FORM OR BY ANY MEANS, ELECTRONIC OR MECHANICAL, INCLUDING PHOTOCOPYING, RECORDING, OR BY ANY INFORMATION STORAGE AND RETRIEVAL SYSTEM, WITHOUT THE WRITTEN PERMISSION OF JACQUES WHITFORD.

FILE: 14677\WORKING\PERTH-ANDOVER-FLORENCEVILLE

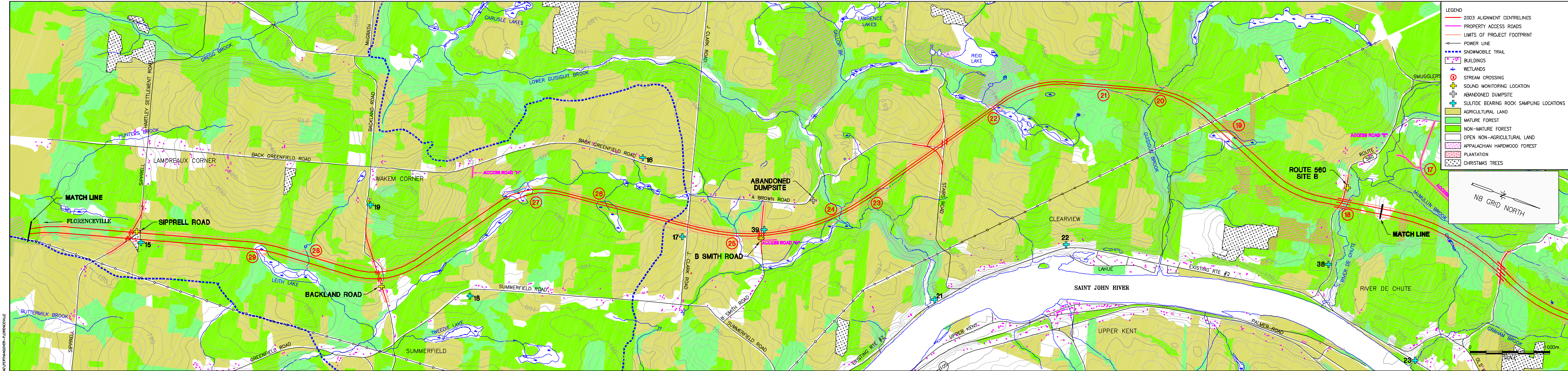

- LEGEND**
- 2003 ALIGNMENT CENTRELINES
 - PROPERTY ACCESS ROADS
 - LIMITS OF PROJECT FOOTPRINT
 - POWER LINE
 - - - SNOWMOBILE TRAIL
 - + BUILDINGS
 - + WETLANDS
 - + STREAM CROSSING
 - + SOUND MONITORING LOCATION
 - + ABANDONED DUMPSITE
 - + SULFIDE BEARING ROCK SAMPLING LOCATIONS
 - AGRICULTURAL LAND
 - MATURE FOREST
 - NON-MATURE FOREST
 - OPEN NON-AGRICULTURAL LAND
 - APPALACHIAN HARDWOOD FOREST
 - + PLANTATION
 - + CHRISTMAS TREES

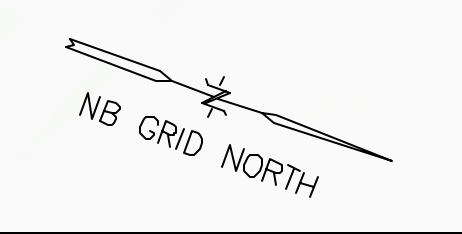

NOTE:
ALL LAND USE SHADING BASED ON FOREST INVENTORY MAPPING (1996/2000)

PROPOSED ALIGNMENT
NEW ROUTE 2 TRANS-CANADA HIGHWAY PROJECT
PERTH-ANDOVER TO WOODSTOCK

Date: 2004 02 03
Job No.: 14677

Scale: 1 : 20 000
Fig. No.: 3.2-B

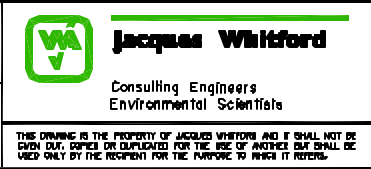

FILE: 14677\WORKING\PERTHANDOVER-FLORENCEVILLE

THIS DRAWING IS THE PROPERTY OF JACQUES WHITFORD AND IT SHALL NOT BE USED FOR ANY OTHER PROJECT WITHOUT THE WRITTEN PERMISSION OF JACQUES WHITFORD CONSULTING ENGINEERS ENVIRONMENTAL SCIENTISTS